

Central Fastener 40 SVL

Application:

Special applications. The slide-in anchor, with an anti-twist feature, can be fixed in the profile t-slot at any point. The anchor is held in position by a spring-loaded ball in the opposing profile t-slot. Can be used for parallel and transverse connections.

Assembly:

Bore hole for the barrel housing: Ø 12 mm, 20 mm from profile end, 30 mm deep.

Bore for anchor in the profile: Ø 8.5 mm, 20 mm from profile end, 25 mm deep.

Material: Steel, zinc-plated

System: 40 - Slot 8

Type: Fasteners



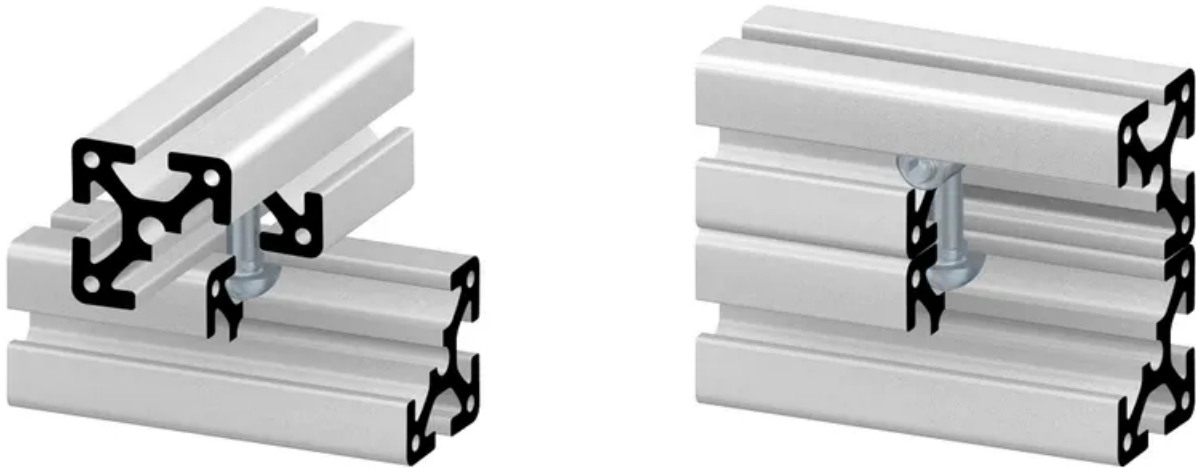

General Data

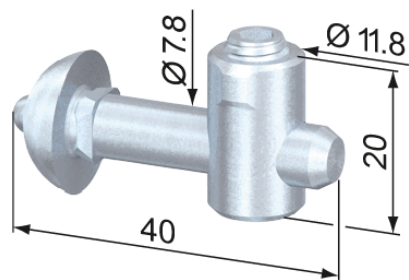

Designation	Description	System	Weight (g)
RF1157	Central Fastener 40 SVL	40 - Slot 8	31