

## WRC Rail

Counterbore from above.

Cut to length acc. to request.

Rails can be joint together for extra long lengths.

Contact Rollco for more information.

Dimensions in mm.



## General Data

| Designation | Weight Rail (g/m) | Length (mm) |
|-------------|-------------------|-------------|
| WRC21/15    | 3596              | 4000        |
| WRC27/20    | 5259              | 4000        |

## Dimensions

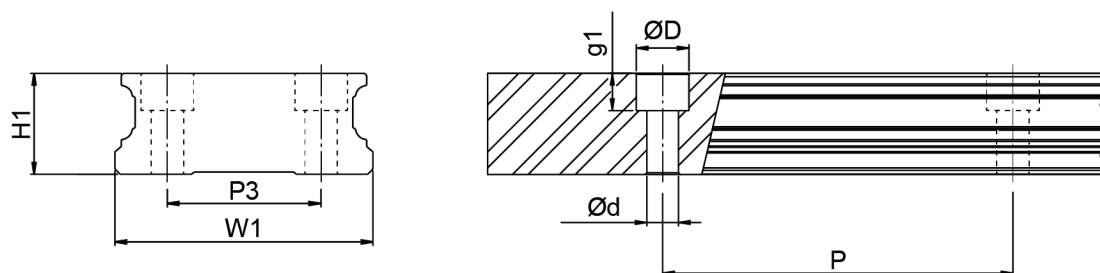

| Designation     | H1   | W1 | D x d x g1      | Hole Pitch (P) | P3 |
|-----------------|------|----|-----------------|----------------|----|
| <b>WRC21/15</b> | 14.4 | 37 | 7.5 x 4.5 x 5.3 | 50             | 22 |
| <b>WRC27/20</b> | 18.5 | 42 | 7.5 x 4.5 x 5.3 | 60             | 24 |