

## Central Fastener 40 120°

### Application:

Fastener for 60° mitered joint, cut angle is 60°

### Assembly:

Bore hole for the barrel housing (2x): Ø 12 mm, 33 mm from profile end, 30 mm deep.

Bore for center hole on end of profile for anchor (2x): Ø 8.5 mm, 50 mm deep; Ø 10 mm, 26 mm deep.

**System:** 40 - Slot 8

**Type:** Fasteners

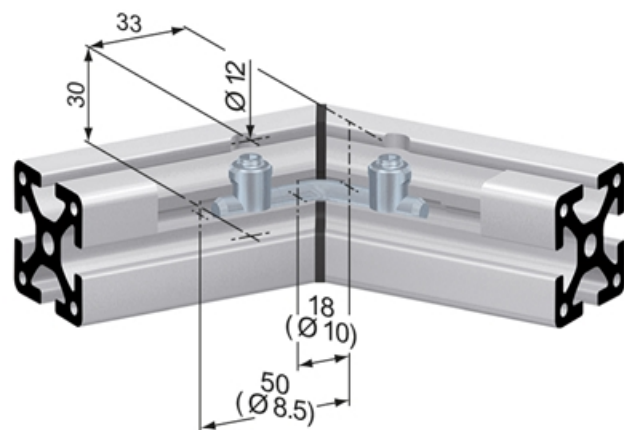
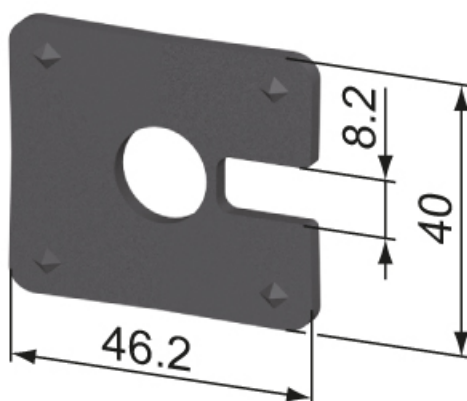
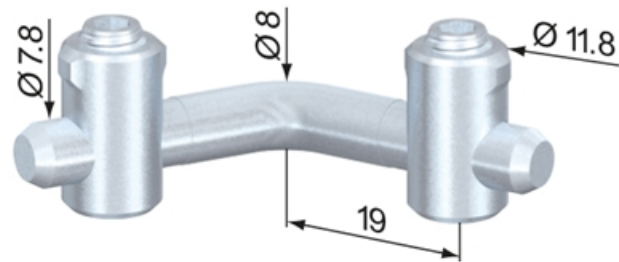

## General Data

| Designation | Description              | System      | Material           | Weight (g) |
|-------------|--------------------------|-------------|--------------------|------------|
| SV1640V     | Central Fastener 40 120° | 40 - Slot 8 | Steel, zinc-plated | 40         |